



# INSTRUCTION BULLETIN

No. 9014345  
Machine: T17  
Published: 01-2016  
Rev. 00

**NOTE: DO NOT DISCARD the Parts List from the Instruction Bulletin. Place the Parts List in the appropriate place in the machine manual for future reference. Retaining the Parts List will make it easier to reorder individual parts and will save the cost of ordering an entire kit.**

*NOTE: Numbers in parenthesis ( ) are reference numbers for parts listed in Bill of Materials.*

Installation instructions for **kit number 9014344**

## SYNOPSIS:

This kit contains the parts needed to replace the side brush hose on T17 scrubbers equipped with the optional scrubbing side brush.

Please follow step-by-step instructions.

## SPECIAL TOOLS / CONSIDERATIONS: NONE

(Estimated time to complete: 1 hour)

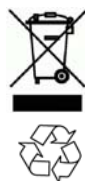

### PROTECT THE ENVIRONMENT

Please dispose of packaging materials, used machine components such as batteries and fluids in an environmentally safe way according to local waste disposal regulations.

Always remember to recycle.

## PREPARATION:

1. Completely empty the solution tank. Refer to the Operator Manual for instructions how to empty the solution tank.
2. Park the machine on a clean level surface, turn off the machine, set the parking brake, and remove the key.

**FOR SAFETY: Before leaving or servicing machine, stop on level surface, turn off machine, and remove key.**

3. Remove the squeegee assembly from the side brush assembly. Refer to the Operator Manual for instructions how to remove the squeegee from the side brush assembly. Set the squeegee assembly aside.
4. Remove the brush from the side brush assembly. Refer to the Operator Manual for instructions how to remove the brush from the side brush assembly. Set the side brush aside.

**INSTALLATION:**

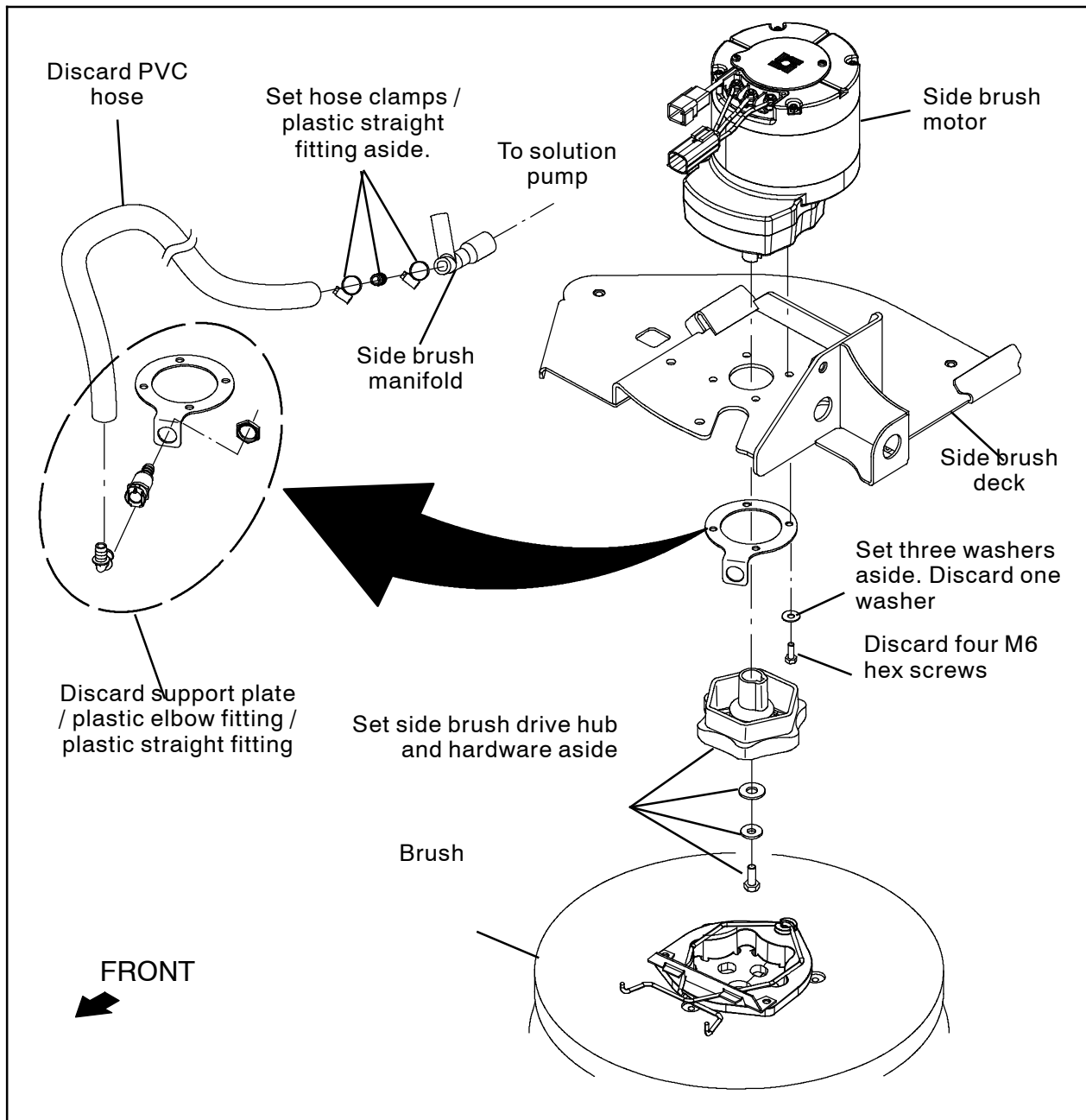

**FIG. 1**

1. Remove the side brush drive hub from the side brush assembly. Set the side brush drive hub and mounting hardware aside. (Fig. 1)
2. Remove the support plate from the side brush assembly. Set three flat washers aside. Discard the four M6 hex screws, the support plate / fittings, and one flat washer. (Fig. 1)
3. Disconnect the PVC hose from the straight fitting installed on the support plate. (Fig. 1)
4. Disconnect the solution supply PVC hose from the side brush manifold. Set both hose clamps and the plastic straight fitting aside. (Fig. 1)

5. Insert the plastic straight fitting into the new 39 in. (991 mm) PVC hose (1) and use a saved hose clamp to secure the fitting inside the PVC hose. (Fig. 2)
6. Use the remaining saved hose clamp to connect the 39 in. (991 mm) PVC hose (1) to the side brush manifold. (Fig. 2)
7. Use three M6 hex screws (3) and saved flat washers to secure the side brush motor to the side brush deck. (Fig. 2)
8. Route the 39 in. PVC down underneath the side brush assembly. (Fig. 2)
9. Slide the cable clamp (2) onto the loose end of the 39 in. (991 mm) PVC hose (1) and position the cable clamp so approximately 0.25 in. (7 mm) of the PVC hose protrudes from the cable clamp. (Fig. 2)
10. Use the remaining M6 hex screw (3) to install the cable clamp (2) onto the side brush assembly. (Fig. 2)
11. Reinstall the brush drive hub onto the side brush assembly. (Fig. 1)

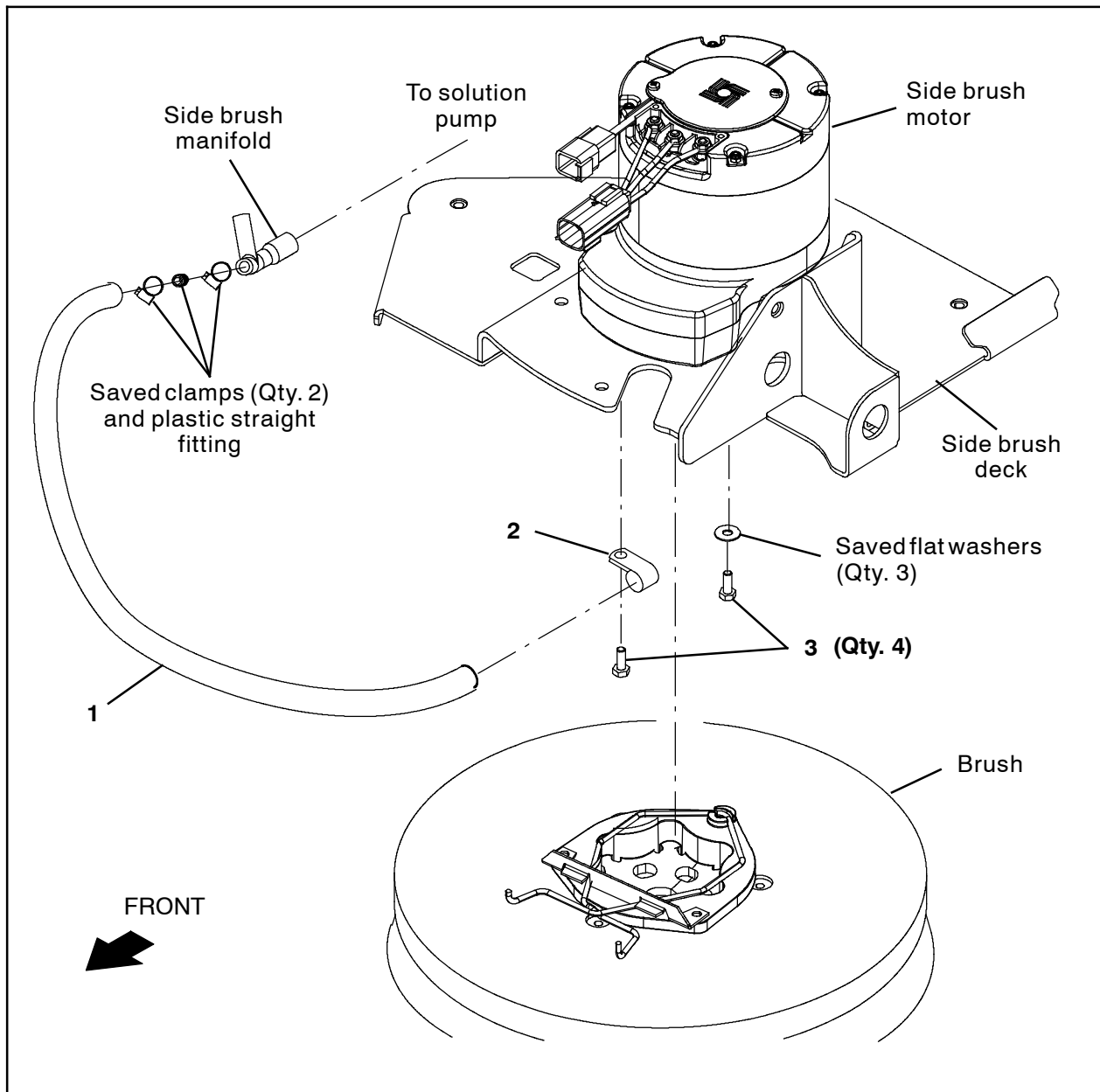

FIG. 2

12. Reinstall the brush and squeegee assembly onto the side brush assembly.

14. Test the machine. Check the new PVC hose connections for leaks.

13. Refill the solution tank. Refer to the Operator Manual for instructions how to refill the solution tank.

---

**Bill Of Materials For Hose Kit, Brush, Side [T17] - 9014344**

<b>Ref.</b>	<b>Tennant Part No.</b>	<b>Description</b>	<b>Qty.</b>
1	376720	Hose, PVC, Brd, 0.38ID 0.60OD, Bulk, Clr (39 in. / 991 mm)	1
2	26395- 1	Clamp, Cable, Stl, 0.56D X 0.38W, 1Hole	1
3	11635	Screw, Hex, M6 X 1.00 X 12, NL, SS	4

TENNANT COMPANY  
P. O. Box 1452  
Minneapolis, MN 55440-1452